



**BLADE 150**  
RY-150BL



**SPARES**

**BODY PARTS**

## INDEX

<b>ASSY NO.</b>	<b>DESCRIPTION</b>	<b>PAGE NO.</b>
A1	FRAME ASSY	1
A2	STEERING STEM ASSY	2
A3	HANDLE BAR ASSY	3-4
A4	FRONT LIGHTS	5
A5	REAR LIGHTS	6
A6	SPEEDOMETER ASSY	7
A7	ELECTRICAL PARTS	8
A8	PAINTED PLASTIC PARTS	9-10
A9	OTHER PLASTIC PARTS	11
A10	SHOCK ABSORBERS	12
A11	SEAT/CARRIER	13
A12	FUEL TANK ASSY	14
A13	AIR CLEANER/CARBURETOR ASSY	15
A14	FOOTREST ASSY	16
A15	REAR FORK ASSY	17
A16	MUFFLER ASSY	18
A17	PEDALS	19
A18	BRAKE ASSY	20
A19	WHEEL ASSY	21-22
A20	CONTROL CABLES	23
A21	LOCK SET	24
A22	BATTERY	25
A23	TOOLS	26
A24	FASTENERS	27-29

### A1 - FRAME ASSY



S.NO.	PART CODE	DESCRIPTION	QUANTITY
A1-1	P13BA0007A	FRAME BODY	1
A1-2	P13A2607A	UPPER ENGINE HANGER, L	1
A1-3	P13A2707A	UPPER ENGINE HANGER, R	1
A1-4	P13P0937A	BRACKET, HORN	1
A1-5	P13A2407A	ENGINE SUPPORT BRACKET	1
A1-6	P13P6617A	BRACKET, FUEL TANK COVERS	1
A1-7	P13J300CX	COLLAR, ENGINE HANGER	1
A1-8	P13J310CX	COLLAR, FUEL TANK	1
A1-9	P134A110CX	SIDE STAND	1
A1-10	P17K020CX	SPRING, SIDE STAND	1
A1-11	P13P6287A	BRACKET, REAR BRAKE SWITCH	1
A1-12	P13P047	ENGINE MUD GUARD	1
A1-13	P13P803LH	BRACKET, CLUTCH CABLE	1

**A2 - STEERING STEM ASSY**



S.NO.	PART CODE	DESCRIPTION	QUANTITY
A2-1	P13J0017G	PRESS PAD, HANDLE BAR	2
A2-2	P13B0607G	UPPER CONNECTING PLATE	1
A2-3	P13B05013	STEERING COLUMN	1
A2-4	N00H000	STEERING BEARING ASSY	1

### A3 - HANDLE BAR ASSY

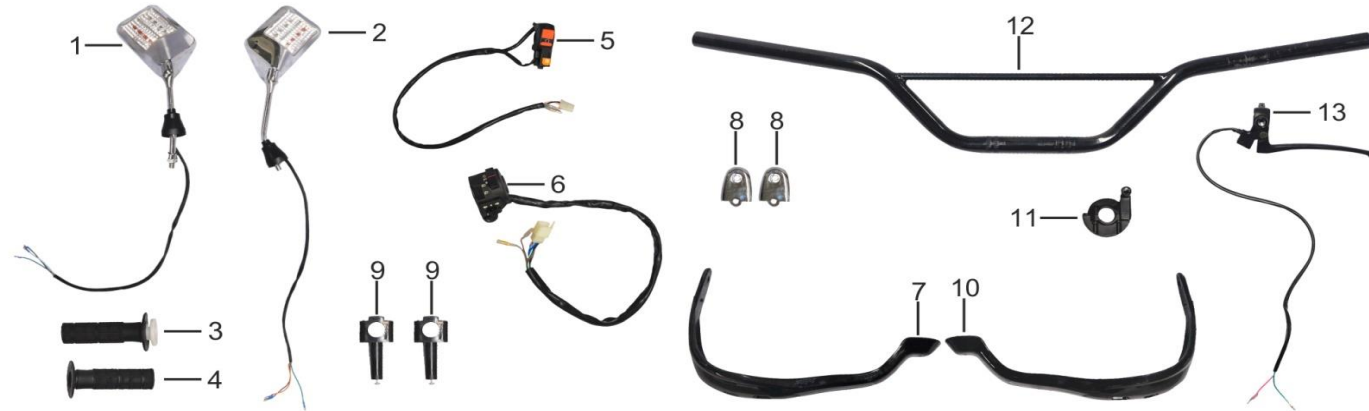

S.NO.	PART CODE	DESCRIPTION	QUANTITY
A3-1	P133C040	REAR VIEW MIRROR, R	1
A3-2	P133C035	REAR VIEW MIRROR, L	1
A3-3	PC2G002	HANDLE GRIP, R	1
A3-4	PC2G001	HANDLE GRIP, L	1
A3-5	P131E080LV	CONTROL SWITCH, R	1
A3-6	P131E070LV	CONTROL SWITCH, L	1
A3-7	P87G0211A	HAND PROTECTOR R, RED	1
A3-7	P87G0218A	HAND PROTECTOR R, WHITE	1
A3-7	P87G0217A	HAND PROTECTOR R, BLACK	1
A3-8	P871P664BCR	PLATE, HAND PROTECTOR	2
A3-9	P87P664	HAND PROTECTOR HOLDER	2
A3-10	P87G0211A	HAND PROTECTOR L, RED	1
A3-10	P87G0218A	HAND PROTECTOR L, WHITE	1
A3-10	P87G0217A	HAND PROTECTOR L, BLACK	1
A3-11	P13E082	THROTTLE CABLE HOLDER	1

**A3 - HANDLE BAR ASSY**

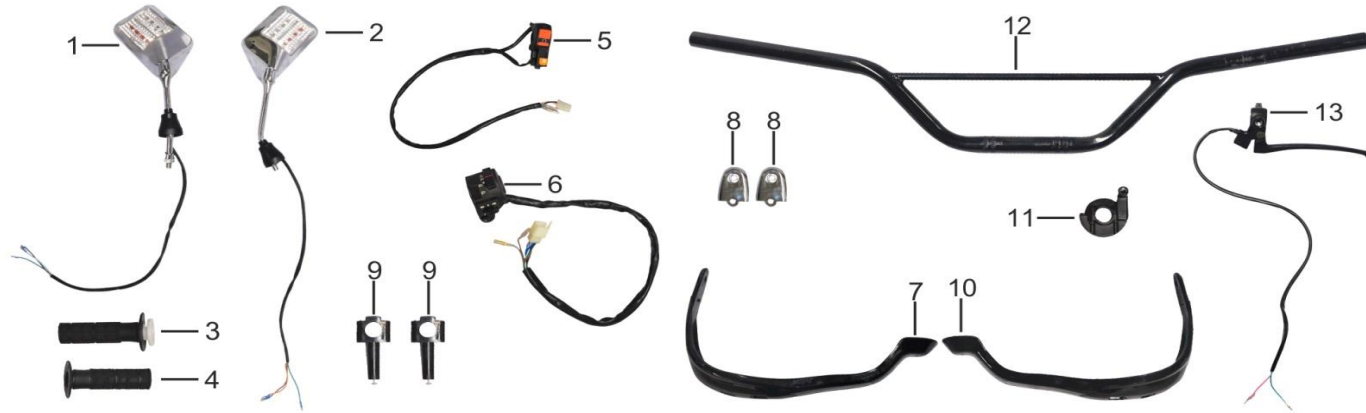

S.NO.	PART CODE	DESCRIPTION	QUANTITY
A3-12	P134A0507A	HANDLE BAR	1
A3-13	P13E100LV	CLUTCH LEVER	1

### A4 - FRONT LIGHTS



S.NO.	PART CODE	DESCRIPTION	QUANTITY
A4-1	P13P1497A	BRACKET, HEADLIGHT	1
A4-2	N565E1401	HEADLIGHT ASSY	1
A4-3	L00E3500008	BULB, HEADLIGHT	1
A4-4	P13E180	FRONT TURN LIGHT, R	1
A4-5	P13E170	FRONT TURN LIGHT, L	1

### A5 - REAR LIGHTS



S.NO.	PART CODE	DESCRIPTION	QUANTITY
A5-1	P13E210	TAIL LIGHT ASSY	1
A5-2	P13E190	REAR TURN LIGHT, L	1
A5-3	P13E200	REAR TURN LIGHT, R	1



**A6 - SPEEDOMETER ASSY**



<b>S.NO.</b>	<b>PART CODE</b>	<b>DESCRIPTION</b>	<b>QUANTITY</b>
A6-1	P138E120J31	SPEEDOMETER ASSY	1
A6-2	P13P0347A	BRACKET, SPEEDOMETER	1

### A7 - ELECTRICAL PARTS



S.NO.	PART CODE	DESCRIPTION	QUANTITY
A7-1	P13EE000	WIRE HARNESS	1
A7-2	N00E020	RECTIFIER	1
A7-3	N00E030	START RELAY	1
A7-4	N00QE004	CATHODE WIRE	1
A7-5	N24E010	IGNITION COIL	1
A7-6	L006E330CX	HORN	1
A7-7	L006E040	FLASHER	1
A7-8	N00E050	CDI	1
A7-9	L004E008	REAR BRAKE SWITCH CABLE	1

### A8 - PAINTED PLASTIC PARTS



S.NO.	PART CODE	DESCRIPTION	QUANTITY
A8-1	P136C2701A	HEADLIGHT COVER, RED	1
A8-1	P136C2708A	HEADLIGHT COVER, WHITE	1
A8-1	P136C2707A	HEADLIGHT COVER, BLACK	1
A8-2	P13C0701AG1A17	SIDE COVER R, RED	1
A8-2	P13C0708AG1A16	SIDE COVER R, WHITE	1
A8-2	P13C0707AG1A18	SIDE COVER R, BLACK	1
A8-3	P13C0651AG1A17	SIDE COVER L, RED	1
A8-3	P13C0658AG1A16	SIDE COVER L, WHITE	1
A8-3	P13C0657AG1A18	SIDE COVER L, BLACK	1
A8-4	P13C3551A	FUEL TANK COVER R, RED	1
A8-4	P13C3558A	FUEL TANK COVER R, WHITE	1
A8-4	P13C3557A	FUEL TANK COVER R, BLACK	1
A8-5	P13C3501A	FUEL TANK COVER L, RED	1
A8-5	P13C3508A	FUEL TANK COVER L, WHITE	1
A8-5	P13C3507A	FUEL TANK COVER L, BLACK	1

### A8 - PAINTED PLASTIC PARTS



S.NO.	PART CODE	DESCRIPTION	QUANTITY
A8-6	P13C0101AG1A06	FRONT FENDER, RED	1
A8-6	P13C0108AG1A10	FRONT FENDER, WHITE	1
A8-6	P13C0107AG1A07	FRONT FENDER, BLACK	1
A8-7	FB03002CX	FLANGE BUSH, FRONT FENDER	3
A8-8	P13G167	RUBBER BUSH, FRONT FENDER	3
A8-9	P13P0167A	SUPPORT BRACKET, FRONT FENDER	1

**A9 - OTHER PLASTIC PARTS**



S.NO.	PART CODE	DESCRIPTION	QUANTITY
A9-1	R37C016	FRONT PART, REAR FENDER	1
A9-2	P13C0171A	MID SUPPORT BRACKET ,REAR FENDER, RED	1
A9-2	P13C0177A	MID SUPPORT BRACKET ,REAR FENDER, BLACK	1
A9-2	P13C0178A	MID SUPPORT BRACKET ,REAR FENDER, WHITE	1
A9-3	P13C265	REAR PARTS, REAR FENDER	1
A9-4	P13P075	BRACKET, LICENSE PLATE	1

### A10 - SHOCK ABSORBERS



S.NO.	PART CODE	DESCRIPTION	QUANTITY
A10-1	PC2B010	FRONT SHOCK ABSORBER, L	1
A10-2	PC2B020	FRONT SHOCK ABSORBER, R	1
A10-3	P13B040	REAR SHOCK ABSORBER, R	1
A10-4	P13B030	REAR SHOCK ABSORBER, L	1
A10-5	PC2P096CX	HOOK, SPEEDOMETER CABLE	1
A10-6	P132P096CX	HOOK, BRAKE OIL PIPE	1
A10-7	P13C360	FRONT REFLECTOR, L	1
A10-8	P13C365	FRONT REFLECTOR, R	1
A10-9	P13P5357A	BRACKET, FRONT REFLECTOR	2

**A11 - SEAT/CARRIER**

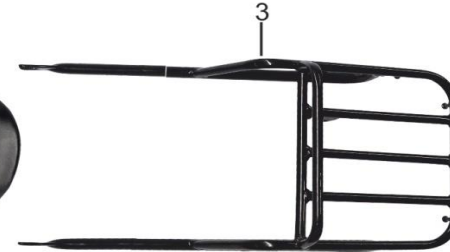
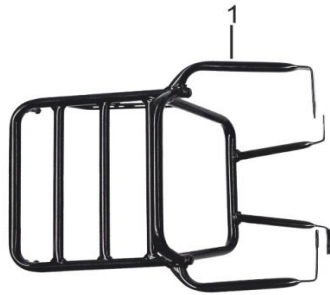

<b>S.NO.</b>	<b>PART CODE</b>	<b>DESCRIPTION</b>	<b>QUANTITY</b>
A11-1	P133A0307A	FRONT CARRIER	1
A11-2	P139C005	SEAT	1
A11-3	P13A010	REAR CARRIER	1

### A12 - FUEL TANK ASSY



S.NO.	PART CODE	DESCRIPTION	QUANTITY
A12-1	P13G147	FUEL TANK FRONT CUSHION RUBBER	2
A12-2	P132C0001AG1A17	FUEL TANK, RED	1
A12-2	P132C0008AG1A16	FUEL TANK, WHITE	1
A12-2	P132C0007AG1A18	FUEL TANK, BLACK	1
A12-3	N26G131	FUEL TANK REAR CUSHION RUBBER	1
A12-4	P13P211	STAY, FUEL TANK	1
A12-5	PC4G022	OIL PIPE	1
A12-6	N00C020	FUEL COCK	1



**A13 - AIR CLEANER/CARBURETOR ASSY**

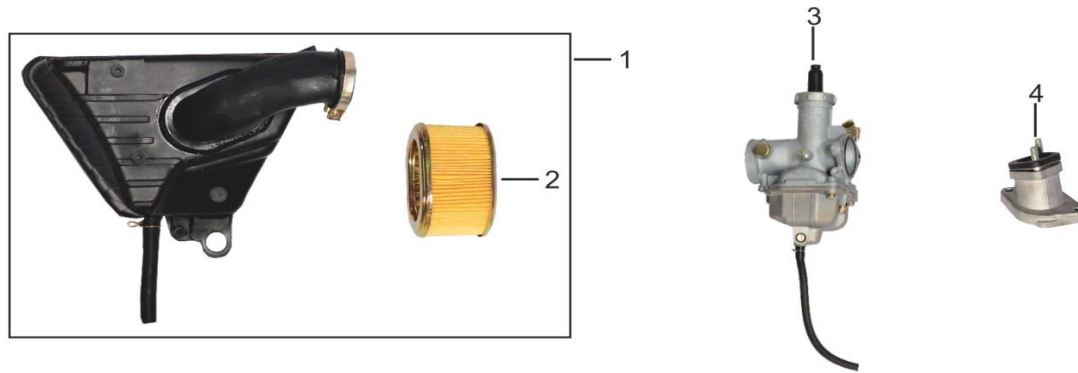

S.NO.	PART CODE	DESCRIPTION	QUANTITY
A13-1	P133Q020	AIR CLEANER ASSY	1
A13-2	P13Q024	AIR FILTER	1
A13-3	P131Q000	CARBURETOR	1
A13-4	L00JQ323	INTAKE PIPE	1

**A14 - FOOTREST ASSY**



S.NO.	PART CODE	DESCRIPTION	QUANTITY
A14-1	P13A130LV	FRONT FOOTREST ASSY, R	1
A14-2	P13A120LV	FRONT FOOTREST ASSY, L	1
A14-3	NENA1147ACX	REAR FOOTREST ASSY, R	1
A14-4	NENA1137ACX	REAR FOOTREST ASSY, L	1

**A15 - REAR FORK ASSY**

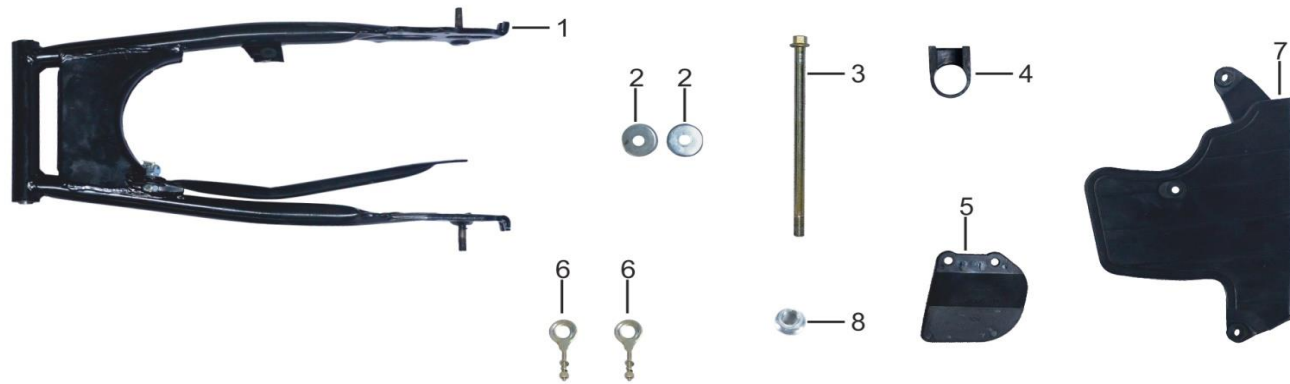

S.NO.	PART CODE	DESCRIPTION	QUANTITY
A15-1	P13A090	REAR FORK	1
A15-2	P132G129	DUST COVER, REAR FORK	2
A15-3	L00LZ028CX	AXLE, REAR FORK	1
A15-4	P13G009	CHAIN GUIDE	1
A15-5	P131C485	CHAIN PROTECTOR	1
A15-6	P132D170CX	CHAIN ADJUSTER, L/R	2
A15-7	P13C180	CHAIN CASE	1
A15-8	618712000XYCX	NUT, REAR FORK AXLE	1

### A16 - MUFFLER ASSY

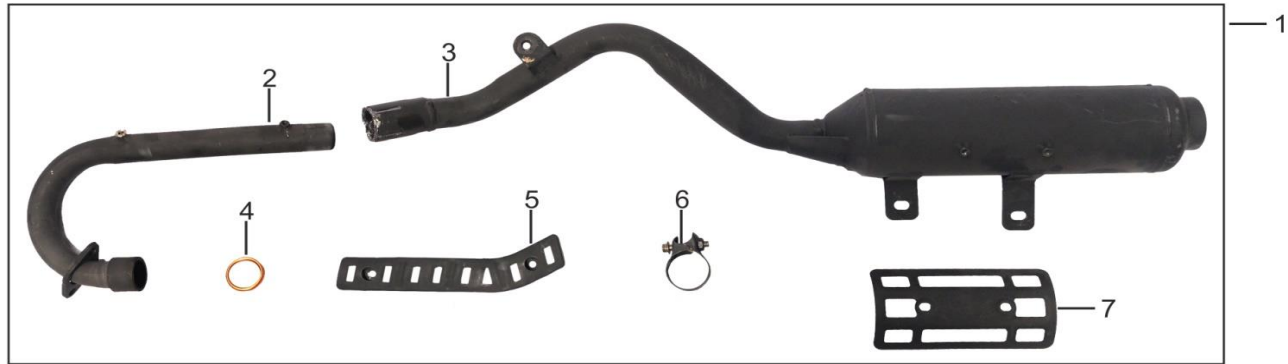

S.NO.	PART CODE	DESCRIPTION	QUANTITY
A16-1	R375Q010	MUFFLER ASSY	1
A16-2	R371Q016	MUFFLER, FRONT PART	1
A16-3	R372Q017	MUFFLER, REAR PART	1
A16-4	R51Q011	GASKET, MUFFLER INLET	1
A16-5	R37Q051	MUFFLER COVER, FRONT	1
A16-6	R37Q01B	CLAMP, MUFFLER	1
A16-7	R37Q052	MUFFLER COVER, REAR	1

**A17 - PEDALS**



S.NO.	PART CODE	DESCRIPTION	QUANTITY
A17-1	P13D180	REAR BRAKE PEDAL	1
A17-2	L00BX38LH	PEDAL GEAR CHANGE	1
A17-3	L00QD38LH	KICK STARTER	1
A17-4	P131K040CX	SPRING, REAR BRAKE PEDAL	1
A17-5	M00K050CX	SPRING, REAR BRAKE SWITCH	1

### A18 - BRAKE ASSY

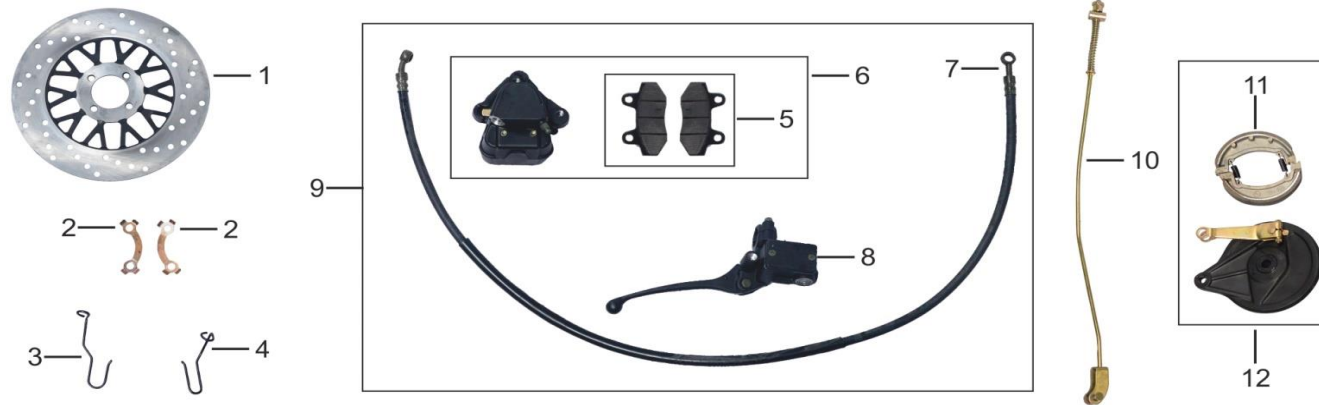

S.NO.	PART CODE	DESCRIPTION	QUANTITY
A18-1	PC22D1317A	DISC PLATE, FRONT DISC BRAKE	1
A18-2	P13D13104CX	LOCK CLIP	2
A18-3	P13P9177A	HOOK (BIG)	1
A18-4	P13P0957A	HOOK (SMALL)	1
A18-5	PC27D134	BRAKE PAD, FRONT DISC BRAKE	1
A18-6	P13D130057G-L	CALIPER ASSY, FRONT DISC BRAKE	1
A18-7	P13D130057G-P	BRAKE OIL PIPE, FRONT DISC BRAKE	1
A18-8	P13D130057G-T	FRONT BRAKE LEVER, WITH UPPER PUMP	1
A18-9	P13D130057G	FRONT BRAKE ASSY	1
A18-10	L00DS175CX	REAR BRAKE ROD	1
A18-11	R841D111	BRAKE SHOE ASSY	1
A18-12	P133D1107GCX	REAR BRAKE PANEL	1

**A19 - WHEEL ASSY**



S.NO.	PART CODE	DESCRIPTION	QUANTITY
A19-1	N56D050	FRONT TYRE	1
A19-2	P132D000BCR1	FRONT RIM	1
A19-3	L00LZ022CX	AXLE, FRONT WHEEL	1
A19-4	PC21D160YH	GEAR, SPEEDOMETER	1
A19-5	PC2J020CX	COLLAR, FRONT AXLE	1
A19-6	P13D040	FRONT TUBE	1
A19-7	618712000XYCX	NUT, FRONT WHEEL AXLE	1

### A19 - WHEEL ASSY



S.NO.	PART CODE	DESCRIPTION	QUANTITY
A19-8	P133D010BCR1	REAR RIM	1
A19-9	L00LZ047CX	AXLE, REAR WHEEL	1
A19-10	P131J040CX	SHORT COLLAR, REAR AXLE	1
A19-11	P132J050CX	LONG COLLAR, REAR AXLE	1
A19-12	N002D152CX	REAR SPROCKET	1
A19-13	894158000	LOCK CLIP	1
A19-14	P13D060	REAR TUBE	1
A19-15	L00DL24	CHAIN	1
A19-16	N56D070	REAR TYRE	1
A19-17	618714000CX	NUT, REAR WHEEL AXLE	1



### A20 - CONTROL CABLES

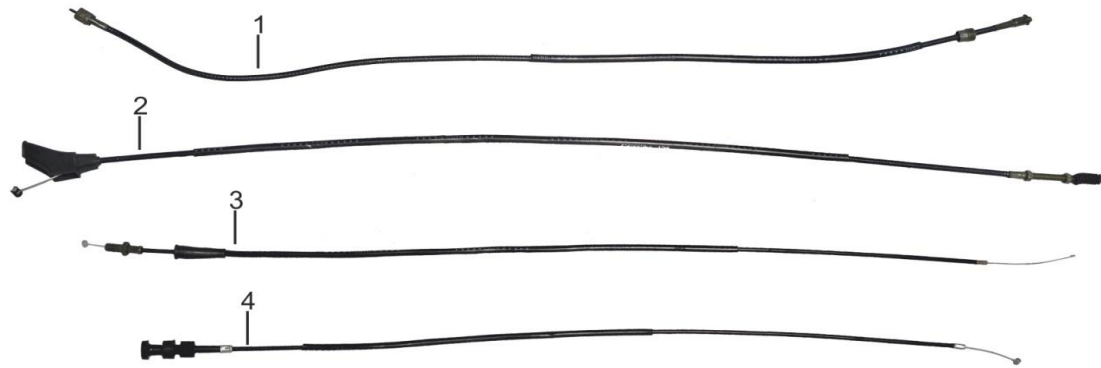

S.NO.	PART CODE	DESCRIPTION	QUANTITY
A20-1	P132F040LV	SPEEDOMETER CABLE	1
A20-2	P131F010LV	CLUTCH CABLE	1
A20-3	P13F020LV	THROTTLE CABLE	1
A20-4	P13F030	CHOKE CABLE	1

**A21 - LOCK SET**



<b>S.NO.</b>	<b>PART CODE</b>	<b>DESCRIPTION</b>	<b>QUANTITY</b>
A21-1	P13K000J3	LOCK SET	1

**A22 - BATTERY**



S.NO.	PART CODE	DESCRIPTION	QUANTITY
A22-1	L00ED89EL2	BATTERY	1
A22-2	R37C185	BRACKET, BATTERY	1
A22-3	PC2G033	BAND BATTERY	1

**A23 - TOOLS**



S.NO.	PART CODE	DESCRIPTION	QUANTITY
A23-1	P02N000J3CX	TOOL KIT	1
A23-2	P13C190	TOOL BOX	1

## A24 - FASTENERS

ASSY NO.	PART NO.	DESCRIPTION	QUANTITY
A1	528708028CX	WASHER Ø8	1
A1	578306012CX	HEXAGON HEAD BOLT M6×12	1
A1	578306016CX	HEXAGON HEAD BOLT M6×16	2
A1	578708030CX	HEXAGON FLANGE BOLT M8×30	1
A1	578708055CX	HEXAGON FLANGE BOLT M8×55	2
A1	578708070CX	HEXAGON FLANGE BOLT M8×70	3
A1	578708090CX	HEXAGON FLANGE BOLT M8×90	2
A1	578710115XYCX	HEXAGON FLANGE BOLT M10×1.25×115	1
A1	617008000CX	I TYPE HEXAGON NUT M8	7
A1	617110000XYCX	I TYPE HEXAGON NUT M10×1.25	3
A1	930008000CX	SPRING WASHER Ø8	7
A1	930010000CX	SPRING WASHER Ø10	2
A1	960006000CX	FLAT WASHER Ø6	3
A1	971008000CX	FLAT WASHER Ø8	7
A1	971010000CX	FLAT WASHER Ø10	2
A3	819006016CX	SLOTTED PAN HEAD SCREW M6×16	2
A4	FB03002CX	BUSH Ø6.5×Ø18×7	2
A4	578706025CX	HEXAGON FLANGE BOLT M6×25	2
A5	578306025CX	HEXAGON HEAD BOLT M6×25	1
A5	578306030CX	HEXAGON HEAD BOLT M6×30	2
A5	960006000CX	FLAT WASHER Ø6	3
A6	FB03002CX	BUSH Ø6.5×Ø18×7	2
A6	617706000CX	HEXAGON FLANGE NUT M6	2
A6	960006000CX	FLAT WASHER Ø6	2
A7	578706012CX	HEXAGON FLANGE BOLT M6×12	3
A8	FB01003CX	FLAT HEAD SCREW M6×16	2
A8	FB01034CX	FLAT HEAD SCREW M6×16	2
A8	FB01038CX	FLAT HEAD SCREW M6×12	2
A8	FB01042CX	FLAT HEAD SCREW M6×12	4
A8	FB03002CX	BUSH Ø6.5×Ø18×7	3

### A24 - FASTENERS

ASSY NO.	PART NO.	DESCRIPTION	QUANTITY
A8	578306025CX	HEXAGON HEAD BOLT M6×25	3
A8	960006000CX	FLAT WASHER Φ6	8
A9	FB02001CX	WASHER Φ6×Φ25×2	3
A9	FB05003CX	CAP NUT M6	1
A9	578306016CX	HEXAGON HEAD BOLT M6×16	2
A9	578306020CX	HEXAGON HEAD BOLT M6×20	1
A9	578306025CX	HEXAGON HEAD BOLT M6×25	1
A9	578706016CX	HEXAGON FLANGE BOLT M6×16	2
A9	617706000CX	HEXAGON FLANGE NUT M6	6
A9	960006000CX	FLAT WASHER Φ6	9
A10	618710000XYCX	HEXAGON FLANGE LOCK NUT M10×1.25	2
A10	818005010CX	SLOTTED PAN HEAD SCREW M5×10	2
A10	923010000XYCX	CAP NUT M10×1.25	2
A10	930005000CX	SPRING WASHER Φ5	2
A10	960010000CX	WASHER Φ10	6
A10	971005000CX	FLAT WASHER Φ5	2
A10	971012000CX	FLAT WASHER Φ12	2
A11	578708016CX	HEXAGON FLANGE BOLT M8×16	3
A11	578708020CX	HEXAGON FLANGE BOLT M8×20	1
A12	FB06007CX	CLIP B9	2
A12	578706016CX	HEXAGON FLANGE BOLT M6×16	1
A13	578706020CX	HEXAGON FLANGE BOLT M6×20	2
A14	578708035CX	HEXAGON FLANGE BOLT M8×35	2
A14	578710020XYCX	HEXAGON FLANGE BOLT M10×1.25×20	2
A16	FB04005CX	FLANGE NUT M6×12-8	2
A16	578306020CX	HEXAGON HEAD BOLT M6×20	3
A16	578708016CX	HEXAGON FLANGE BOLT M8×16	1
A16	617706000CX	HEXAGON FLANGE NUT M6	1
A16	618712000XYCX	HEXAGON FLANGE LOCK NUT M12×1.25	1
A16	960006000CX	FLAT WASHER Φ6	4

### A24 - FASTENERS

ASSY NO.	PART NO.	DESCRIPTION	QUANTITY
A16	960008000CX	WASHER Ø8	1
A16	971012000CX	FLAT WASHER Ø12	1
A17	FB02014CX	WASHER Ø10×Ø25×2	1
A17	578306030CX	HEXAGON HEAD BOLT M6×30	1
A17	617006000CX	I TYPE HEXAGON NUT M6	1
A17	617110000XYCX	I TYPE HEXAGON NUT M10×1.25	1
A17	910020020CX	SPLIT PIN D=2.0, L=20	1
A17	930010000CX	SPRING WASHER Ø10	1
A19	FB04011CX	PIN BOLT Ø10×30-M8×18	1
A19	FB04014CX	BOLT M10×1.25×37	4
A19	617008000CX	I TYPE HEXAGON NUT M8	1
A19	617710000XYCX	HEXAGON FLANGE NUT M10×1.25	4
A19	618712000XYCX	HEXAGON FLANGE LOCK NUT M12×1.25	1
A19	618714000CX	HEXAGON FLANGE LOCK NUT M14	1
A19	882006017CX	PIN Ø6×17	1
A19	894158000	RING STOPPER OD=58, ID=53+0.46-1.10MM	1
A19	910020020CX	SPLIT PIN D=2.0, L=20	2
A19	930008000CX	SPRING WASHER Ø8	1
A19	971006000CX	FLAT WASHER Ø6	1
A19	971010000CX	FLAT WASHER Ø10	1
A21	819006010CX	SLOTTED PAN HEAD SCREW M6×10	4
A22	578708016CX	HEXAGON FLANGE BOLT M8×16	2
A24	578706016CX	HEXAGON FLANGE BOLT M6×16	2
A24	960006000CX	FLAT WASHER Ø6	4



***Raybar***

[www.raybarmotorcycles.com](http://www.raybarmotorcycles.com)

 /raybarmoto